



iCutter SERIES

# iCutter Series HEAVY-DUTY PAPER CUTTERS

PRODUCT OVERVIEW



iCutter 1580

# iCutter Series HEAVY-DUTY PAPER CUTTERS

Mechanical drive paper cutters from Challenge Machinery provide precise, trouble-free operation at an incredible value.

## BACKGAUGE PRECISION

The linear guide rail and A/C driven ball-screw deliver smooth, effortless motion. The precise backgauge controls provide accuracy within +/- 0.002".

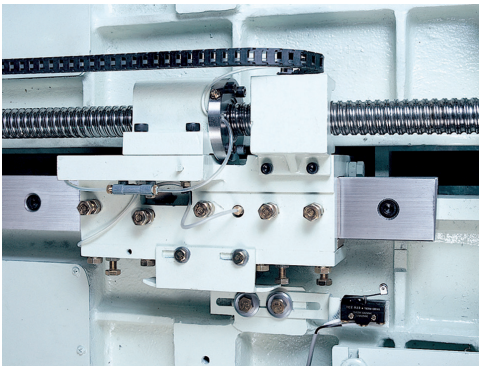

High-speed backgauge

## ADVANCED CONTROL SYSTEM

The large 15" color touchscreen provides a visual display of backgauge location and proper cut sequence alignment and positioning. The advanced user interface includes machine diagnostics, job storage and retrieval capabilities, error detection and maintenance reminders.

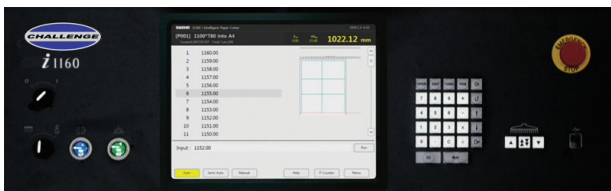

iCutter 1160 control panel

## STRONG FOUNDATION

The heavy duty construction of the cast iron and steel frame provides a solid foundation for consistent cut accuracy. The rugged design of the mechanical drive system is ideal for high volume cutting applications where reliability is critical.

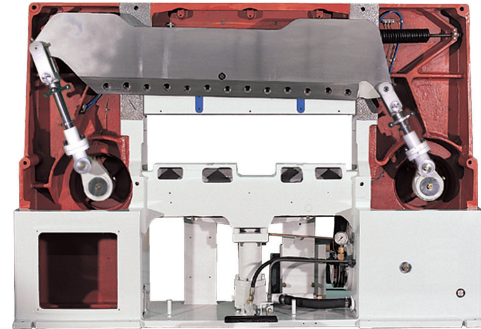

Heavy-duty frame and knife bar design

## KNIFE CHANGING SIMPLICITY

The mechanical knife removal system is designed for efficiency and ease of use. One operator can safely replace the blade in ten minutes.

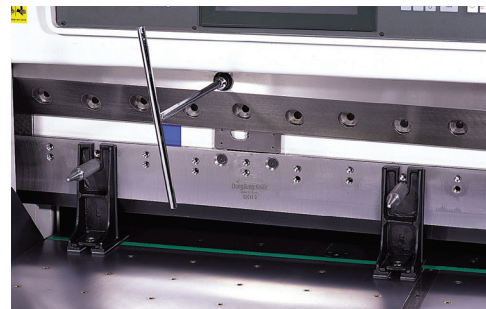

Easy design for knife changes

## SAFETY

Operator safety is of the utmost importance and the iCutter comes standard with key features such as two-hand activation, timed and non-repeating cut buttons, monitored knife safety latch, infrared safety beams, and overload shear bolt.



iCutter 780



CE

The Challenge iCutter series has an optional module that integrates with the HP Indigo workflow package for fully automated cutting jobs. After scanning the job ticket, the iCutter displays the optimal cutting sequence automatically. As an HP SmartStream Partner, labor efficiency can be increased by as much as 170%.



## SUMMARY OF FEATURES

- Manual/semi-automatic and automatic operation modes
- AC servomotor, ball screw and linear guide
- Adjustable clamping pressure
- Table light/optical cut line indicator
- Plated, cast iron air table
- Easy knife change system
- Electro-magnetic clutch and brake system
- Double end pull knife drive system (single end pull on 860 and smaller)
- Shear bolt for cutting system protection
- Two hand cut control with non-repeat safety system
- Infrared safety light curtain
- Closed rear table
- CE listed

# SPECIFICATIONS

CUTTING	1580	1370	1160	860	780	680
Maximum cutting width (A)	62"/1580 mm	53.9"/1370 mm	45.7"/1160 mm	33.9"/860 mm	30.7"/780 mm	26.7"/680 mm
Maximum clamp opening (B)	6.5"/165 mm	6.5"/165 mm	6.5"/165 mm	6.1"/155 mm	5.5"/140 mm	5.5"/140 mm
Feed depth: Max. (C)	62"/1580 mm	53.9"/1370 mm	45.7"/1160 mm	33.9"/860 mm	30.7"/780 mm	26.7"/680 mm
Min.	1.5"/38 mm	1.2"/30 mm	1.2"/30 mm	1.2"/30 mm	1.2"/30 mm	1.2"/30 mm
Cutting speed (r.p.m.)	48	48	48	45	45	45
Drive system	double end pull	double end pull	double end pull	single end pull	single end pull	single end pull
Clamp pressure	440-9,921lbs/200-4,500kg	440-9,921lbs/200-4,500kg	440-9,921lbs/200-4,500kg	440-9,921lbs/200-4,500kg	440-6,613lbs/200-3,000kg	440-6,613lbs/200-3,000kg
Backgauge speed: Max.	7.9 in/sec	7.9 in/sec	7.9 in/sec	7.9 in/sec	7.9 in/sec	7.9 in/sec
Min.	.39 in/sec	.39 in/sec	.39 in/sec	.39 in/sec	.39 in/sec	.39 in/sec
Minimum cut: w/flase clamp	2.95"/7.5 cm	2.95"/7.5 cm	2.95"/7.5 cm	2.95"/7.5 cm	2.95"/7.5 cm	2.95"/7.5 cm
w/out flase clamp	1.5"/38 mm	1.2"/30 mm	1.2"/30 mm	1.2"/30 mm	1.2"/30 mm	1.2"/30 mm

DIMENSIONS	1580	1370	1160	860	780	680
Table space in front of knife (D)	28.3"/720 mm	28.3"/720 mm	28.3"/720 mm	25"/635 mm	25.6"/650 mm	25.6"/650 mm
Table height (E)	35.4"/900 mm	35.4"/900 mm	35.4"/900 mm	34"/865 mm	35.4"/900 mm	35.4"/900 mm
Overall Length (w/side tables) (F)	126.4"/3,210 mm	112.8"/2,715 mm	104.5"/2,655 mm	80.1"/2,035 mm	75.6"/1,920 mm	71.7"/1,820 mm
Overall width (G)	123.6"/3,140 mm	103.5"/2,630 mm	95.3"/2,420 mm	78.4"/1,990 mm	64.6"/1,640 mm	60.7"/1,540 mm
Overall height (H)	67.7"/1,720 mm	65.4"/1,660 mm	65.4"/1,660 mm	60.4"/1,535 mm	59.1"/1,500 mm	59.1"/1,500 mm
Net weight (approx)	13,118 lbs/5,950 kg	11,354 lbs/5,150 kg	9,480 lbs/4,300 kg	5,424 lbs/2,440 kg	4,475 lbs/2,030 kg	4,189 lbs/1,900 kg
Shipping weight (approx)	14,936 lbs/6,530 kg	12,545 lbs/5,690 kg	10,538 lbs/4,780 kg	6,261 lbs/2,840 kg	5,291 lbs/2,400 kg	4,916 lbs/2,230 kg

## ELECTRICAL

- **1580 Motor:** 7.5 HP, 208/230 volts, 60Hz, 3 phase AC, 27.3 amps (service size: 45 amps)
- **1370 Motor:** 5 HP, 208/230 volts, 60Hz, 3 phase AC, 20 amps (service size: 30 amps)
- **1160 Motor:** 5 HP, 208/230 volts, 60Hz, 3 phase AC, 20 amps (service size: 30 amps)

- **860 Motor:** 5 HP, 208/230 volts, 60Hz, 3 phase AC, 20 amps (service size: 30 amps)
- **780 Motor:** 5 HP, 208/230 volts, 60Hz, 3 phase AC, 20 amps (service size: 30 amps)
- **680 Motor:** 5 HP, 208/230 volts, 60Hz, 3 phase AC, 20 amps (service size: 30 amps)

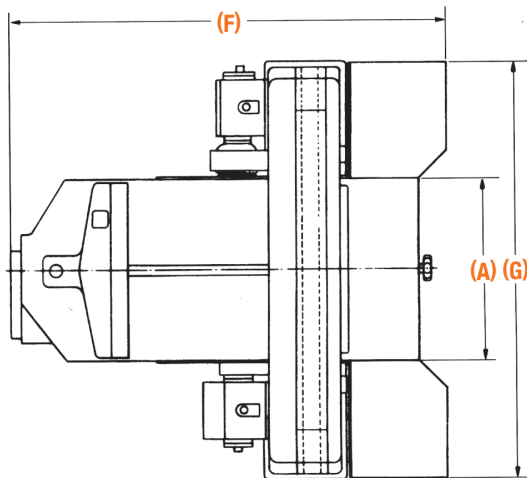

TOP VIEW

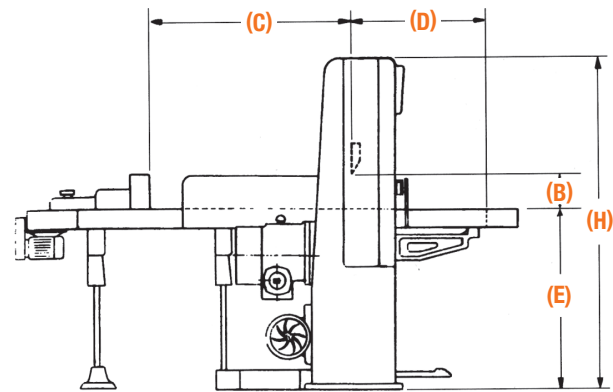

SIDE VIEW



THE CHALLENGE MACHINERY COMPANY  
 6125 Norton Center Dr. Norton Shores, MI 49441 USA  
 P. +1.231.799.8484 F. +1.231.798.1275  
[www.challengemachinery.com](http://www.challengemachinery.com)